

# Ferry County Out Building Application

- |   |        |
|---|--------|
| 1. Will the building be larger than 1000 square feet?   | Yes No |
| 2. Will the building have eave projections greater than 2 feet?   | Yes No |
| 3. Will the building be greater than one story in height?   | Yes No |
| 4. Will the building be closer than 20 feet to a property line or other building?                                 | Yes No |
| 5. Will the building be closer than the height of the building plus 5 feet, to a property line or other building? | Yes No |
| 6. Is there drainage plumbing in the building?  | Yes No |
| 7. Is there hot water supply plumbing in the building?  | Yes No |
| 8. Will the building be a place of human habitation?  | Yes No |
| 9. Will the building be a place of employment?  | Yes No |
| 10. Will the building be used by the public?  | Yes No |
| 11. Is there a residential structure on the property or on contiguous property?                                   | Yes No |

If you answered no to the first ten questions, and yes to the last question, you have the option of either obtaining a Building Permit, or a Partial Exemption Building Permit. **(If you answered yes to any of the first ten questions, or no to the last question, you must obtain a Building Permit, rather than a Partial Exemption Building Permit. If you are adding to an existing building, you do not qualify for a partial exemption.)**

**In order to obtain a Building permit, you must submit construction plans.** A plan review will be performed, inspections will be made, and the fee will be calculated based on the square footage of the structure. If you elect to obtain a Partial Exemption Permit, no plan review or inspections will be made. The only plan required to obtain a Partial Exemption Permit is an accurate plot plan. **The plot plan must show the location of the proposed building in relation to other structures and property lines.**

The fee for a Partial Exemption Permit is \$35.00. We also offer an optional Plan Review service. (Inspections will not be made, but you can verify that the materials you decide to use will meet code.) The fee for the plan review is \$30.00. Partial Exemptions are subject to all Planning Land Use Regulations. If it becomes necessary to make a site visit, a \$30.00 site visit fee will be charged.

All fees can be made payable to the Ferry County Planning Department.

Please circle a choice below:

- Partial Exemption (Flat fee of \$35.00) **See above 11 questions.**
- Building Permit (Fee determined based on sq. footage, and no additional fees are collected. Plan review and shoreline staking are included in the permit fee.)

# OUT BUILDING

## FERRY COUNTY BUILDING PERMIT CHECKLIST

1. Is there any water: river, creek, lake, pond, or wetland (circle all that apply), on or near your property?  
If yes, what is the distance between the building site and the water? \_\_\_\_\_
2. Are you planning to move over 500 cubic yards (50 dump truck loads) during building? (circle one) Yes -- No
3. Are you planning to move over 250 cubic yards (25 dump truck loads) during building? (circle one) Yes -- No
4. What is the size of your property? \_\_\_\_\_
5. Will proposed building have plumbing? (circle one) Yes -- No
6. Will you be building yourself or hiring a contractor? (circle one)

A COPY OF THE CONTRACTOR'S CURRENT LICENSE MUST BE PROVIDED TO THE PLANNING DEPARTMENT BEFORE A BUILDING PERMIT WILL BE ISSUED.

7. Have you applied for a road approach permit? (circle one) Yes -- No -- N/A
8. What is your physical address? \_\_\_\_\_  
If you do not have a physical address, please apply for one at the 911 Office in the Sheriff's Department.
10. Do you have any easements or right-of-ways on your property? (circle one) Yes -- No  
It is the landowner's responsibility not to encroach on any easements or right-of-ways.
11. Is the property within the jurisdiction of other agencies or a Home Owner's Association? (circle one) Yes -- No  
If yes, it is the responsibility of the applicant to acquire said permit(s), and to comply with all applicable rules, regulations, ordinances, and/or restrictive covenants of those jurisdictions.

NAME: \_\_\_\_\_ PHONE: \_\_\_\_\_



Ferry County  
**PLANNING DEPARTMENT**  
 Post Office Box 305  
 Republic, WA 99166 - 0305  
 Telephone (509) 775-5209  
 Fax (509) 775-5240

# OUTBUILDING BUILDING PERMIT APPLICATION

Directions to job site and physical address:

A permit will NOT be issued until all questions are answered and requirements are met. An accurate plot plan must be submitted before a permit can be issued.

Property Owner \_\_\_\_\_

Mailing Address \_\_\_\_\_

City \_\_\_\_\_

State, Zip \_\_\_\_\_

Phone \_\_\_\_\_

Tax Parcel # \_\_\_\_\_

Contractor \_\_\_\_\_

Contractor Street Address \_\_\_\_\_

Contractor City, State, Zip \_\_\_\_\_

License # \_\_\_\_\_

Contractor Phone \_\_\_\_\_

Describe fully the intended use of the structure:

\_\_\_\_\_

Proposed Start Date \_\_\_\_\_

**Septic Permit #** \_\_\_\_\_

Permit becomes VOID if construction has not started within 12 months of issuance OR if work is suspended for more than 180 days, unless a written request for an extension is received.

**I certify that I have read and understand this application and know the same to be true and correct. All provisions or laws and ordinances governing this type of work will be complied with whether specified herein or not.**

Owner Signature \_\_\_\_\_

Agent's Signature \_\_\_\_\_

\_\_\_\_\_

\_\_\_\_\_

\_\_\_\_\_

\_\_\_\_\_

\_\_\_\_\_

Shoreline Permits may be required for projects when located 200 feet landward of a protected shoreline. Structures located in the 100-year flood plain are subject to the Flood Damage Prevention Ordinance and must have a flood area compliance endorsement. Issuance of a building permit does not exempt these or any other ordinances when applicable.

**OFFICE USE ONLY**

	Dimensions	Sq. Feet	Cost per	Valuation
Garage	_____ x _____	= _____	x _____	= _____
Carport	_____ x _____	= _____	x _____	= _____
Deck	_____ x _____	= _____	x _____	= _____
Foundation--Linear Feet	_____	x _____	= _____	
Slab	_____ x _____	= _____	x _____	= _____
Out-building	_____ x _____	= _____	x _____	= _____
Other	_____ x _____	= _____	x _____	= _____

Total Square Footage = \_\_\_\_\_

Total Value = \$ \_\_\_\_\_

Permit Fee = \$ \_\_\_\_\_

State Building Code Fee = \$ \_\_\_\_\_

Date & Received by \_\_\_\_\_ Total Fee = \$ \_\_\_\_\_

Permit # \_\_\_\_\_

Date Issued \_\_\_\_\_

Valuation \_\_\_\_\_

**THIS PAGE LEFT BLANK INTENSIONALLY.**

# sample plot plan

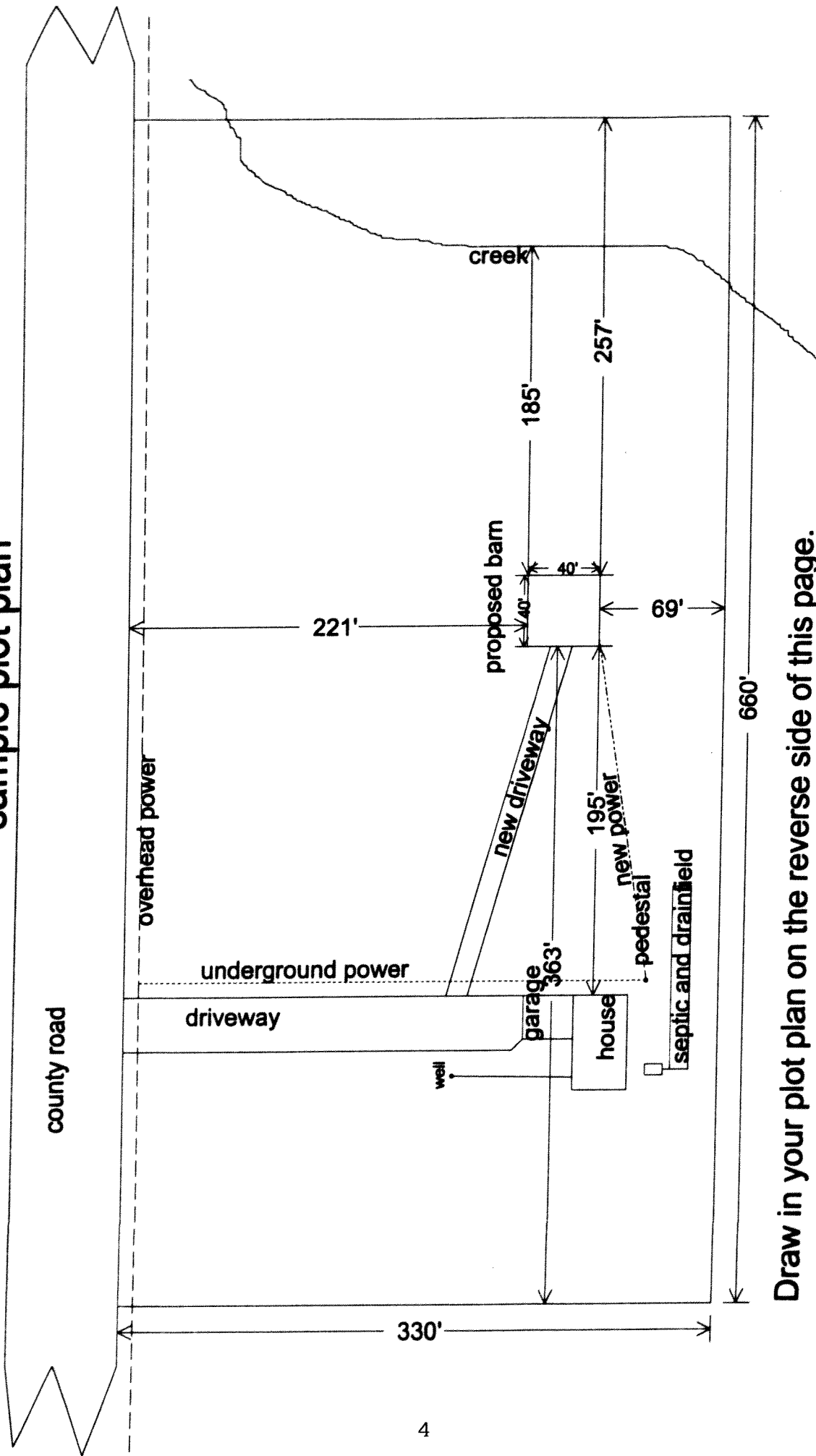

Draw in your plot plan on the reverse side of this page.

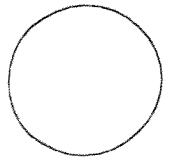

# Plot Plan

show direction of north in circle